



LAC Alarm System

Quick Guide for Android and iOS

NOTES:
Before supplying power to the camera, please read this User Guide in detail.

Do not attempt to disassemble the camera. If the camera is not working, please contact your local supplier

Please Read Before Using This Product

Rover System does not control and is not responsible for, the availability, stability, privacy policy of any product or services provided by a third-party, which includes, but is not limited to, the services offered by the customer's Internet Service Provider, Dynamic DNS (e.g. DynDNS and the likes) and contracted software or services like P2P Cloud services. The afore - mentioned services are identified below:

Internet Service Provider (ISP) – the company contracted to provide internet service to client location, which is being used as a medium in which the device/s acquired from Rover System may become available, viewable and/or configurable "online". Hence, large upstream bandwidth must be provided to transmit good quality videos. Limited bandwidth and network traffic may still be experienced causing delays on remote monitoring during peak hours.

Dynamic DNS (Domain Name System) – a service which maps a changing or dynamic IP address into a website address. Since some home and entry business subscription from ISPs are provided with dynamic IP addresses, as opposed to statically assigned IPs, it will be a challenge to monitor and access a device within the subscriber's network and the address changes occasionally. DNS are maintained by third party providers, therefore, any disconnection or network related issues may cause failure of DNS host.

P2P Cloud hosting service – a service which hosts a platform for de-centralized internet connected devices without the tedious setup, normally done to securely access a device from internet. The handshakes are usually occurring at the platform of the service provider. Since P2P Cloud Services are free and open to the public, network traffic due to multiple connections cannot be avoided and thus, may cause remote monitoring problems.

Limited Warranty

We appreciate your purchase of Rover Systems Security Products. We take pride in the quality of our products which has been supplied and installed to exacting quality standards. We feel confident that in normal use, it will provide you with years of satisfactory performance.

Rover Systems ("The Company") warrants to the original user that the products supplied is free of any rightful claim of infringement. When use in the manner intended, it will be free of defects in materials and workmanship for a period of one (1) year upon the date of purchase, provided

1. The Company is notified within such period by return of any alleged defective product, free and clear all liens and encumbrances; transportation prepaid;
2. The Products were not abused, misused or improperly maintained and/or repair by any unauthorized service personnel during such period; and
3. Such defect was not caused by ordinary wear and tear; and
4. Such defect is not the result of voltage surges/brownouts, lightning, water damage, flooding, fire explosion, earthquakes, tornadoes, act of aggression/war or similar phenomenon; and
5. Accessories used as integrant to the proper functioning of the Product; but not purchased from the Company, must be approved by the Company (e.g. power supplies, connectors, etc.)

The Company's obligation under this warranty shall be limited to the repair, or at its option, exchange of the equipment, that shows evidence of manufacturing defect within the warranty period.

Replacement parts furnished in connection with this warranty shall be limited to the repair, or at its option, the exchange of the equipment, that shows evidence of manufacturing defect within the warranty period.

In case the equipment must be repaired abroad in the country of origin and manufactured, all freight charges, as well as accompanying import duties and taxes shall be shouldered by the customer.

The Company and its suppliers reserves the right to make changes in design, or to make additions to, or improvements upon the product without incurring any obligation to install the same on products previously manufactured and sold. The original date of the Delivery Receipt (DR) or Sales Invoice (SI) should be kept as proof of purchase and must be presented to the Company's Authorized Service Center, together with this warranty card, when the equipment is to be serviced under the provisions of this warranty. Transportation to and from the Service Center is responsibility of the user.

The Company's sole liability and the customer's exclusive remedy for damages, regardless of the theory, shall not exceed the cost of correcting the defect and in no event shall such a liability be greater than the purchase price paid to Company for the products. The Company shall not under any circumstance be liable for special, indirect or consequential damages of any kind. The Company shall not be liable in any loss of video recording.

The foregoing is in lieu of all warranties, expressed or implied, including but not limited to, the implied warranties of merchantability and fitness for a particular purpose. The Company neither assumes nor authorizes any person to assume for it any obligation or liability in connection with the sale of its products. In no event shall the Company or its dealers be liable for special or consequential damages arising from the use of its products, or any delay performance of this warranty due to causes beyond its control.

IMPORTANT NOTES:

1. Please keep this PROOF OF WARRANTY including the Delivery Receipts or Sales Invoice when calling for maintenance.

PROTECT YOUR ELECTRONIC SECURITY SYSTEM To Our Valued Client,

Please be advised that the Electronic Security Equipment are sensitive to voltage surges. In fact, majority of defects are caused by unstable 220VAC power supply, power fluctuations, and transient surges. Further, failure of equipment is usually experienced after a brownout or after a thunderstorm.

In general, we recommend that you purchase Rover Regulated Power Supply and Automatic Voltage Regulator with Power-On-Delay considering that these have been tested to protect against the most common causes of damage to Electronic Security System.

Failure to protect your system with the above-mentioned equipment may void your one (1) year warranty especially if the damaged equipment sustain burnt marks, which is an evidence of power fluctuations or surges due to brownouts, lightning strikes, and unstable power supply.

However the use of Rover Regulated Power Supply and AVR with Power-On-Delay is not a guarantee that your equipment will not sustain damage due to power fluctuations and transient surges as the above-mentioned products can only protect the equipment to a certain degree. If the customer knows his area has power fluctuation problems, we recommend the use of high grade AVRs such as Servo Motor Automatic Voltage Regulator with Power-On-Delay and/or True-On Line Uninterruptible Power Supply (UPS). Further, we also recommend the use of Network Surge Protection Device.

For Lightning Strike prone areas, we recommend that you protect your CCTV equipment with Lightning Arresters.

Thank you very much,

ROVER SYSTEMS

Technical Support
Tel No. (632) 8723-7959 loc. 1147 to 1150

INTERFACE

A. Camera Alarm Panels

LAPC22GE8F



IR
Lens
Speaker

LAN Port
Microphone

LADC22GB8F

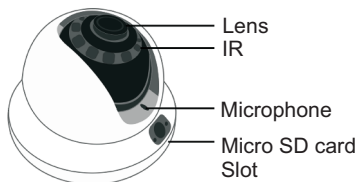

Lens
IR
Microphone
Micro SD card Slot

LABC23GC8F

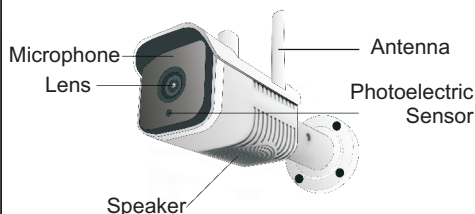

LAP108F

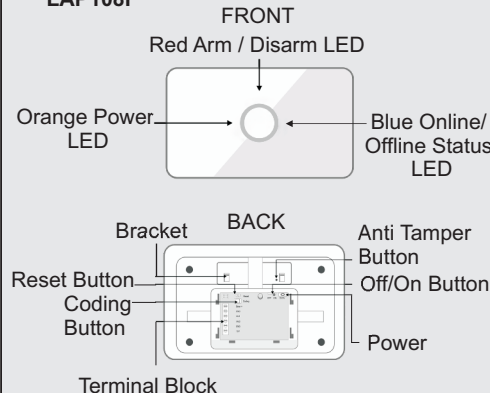

B. Sensors

LAS218F

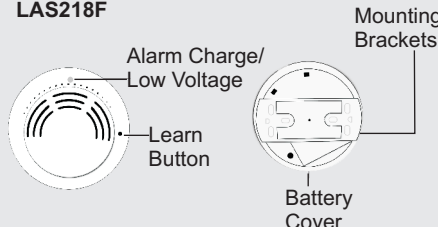

LAM128F

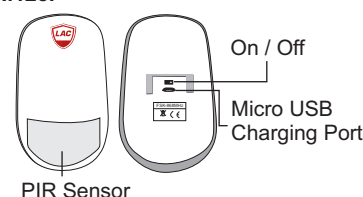

LAD038F

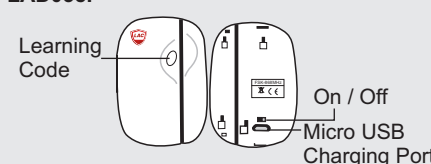

C. Siren

LAJ918F

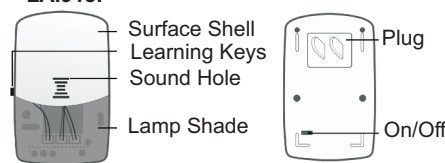

On/Off

D. Keyfob

LAR828F

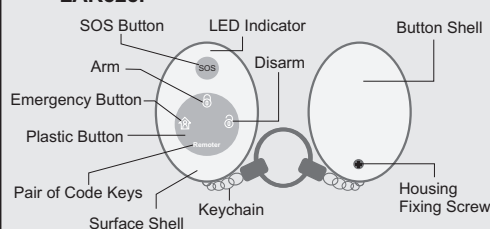

E. Wireless Transmitter

LAT248F

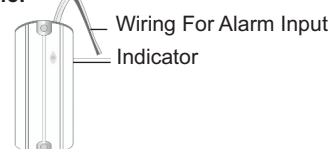

SYSTEM DIAGRAM

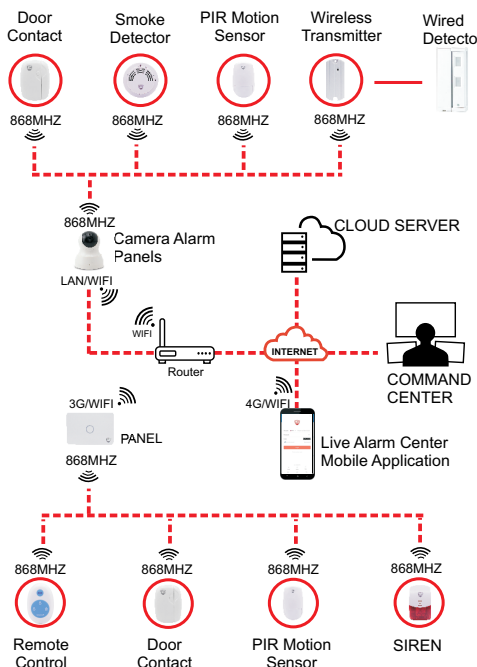

INSTALLATION CONSIDERATION

1. Check access to power outlets and LAN Port for Internet access.
2. Check Wi-Fi connection signal strength at each camera/panel location. (For Wireless Connection Mode)
3. Check for lighting issues that may impact image quality.
4. Check camera angle it should be in the most optimal location and not leaving any blind spots
5. The minimum distance of wireless sensors to the camera or panel is up to 30 meters LINE OF SIGHT.

1. Download and Register to Live Alarm Center Mobile Application

Download Live Alarm Center Mobile Application on App Store for iOS and Play Store for Android user.

Click "Register" to create new account

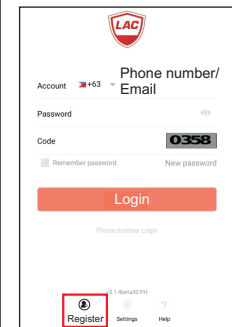

Input mobile number and code then proceed to registration



* Specifications are subject change without prior notice LAC Alarm System | Page 11

4.2 Configuration of sensors to alarm panel

Click "Click to configure" or ">" for further settings

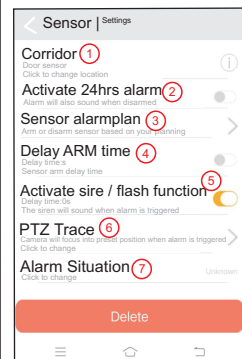
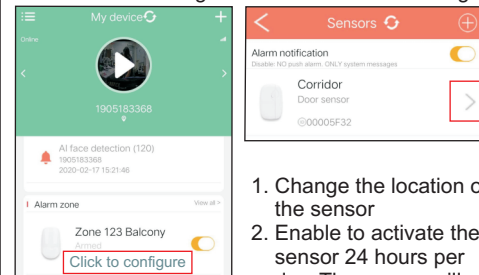

1. Change the location of the sensor
2. Enable to activate the sensor 24 hours per day. The sensor will also trigger even when the alarm system is in disarm mode.
3. Schedule the arming and disarming of the sensor.
4. Set the delay arming time of the sensor
5. Enables the siren to sound when alarm is triggered
6. Set the pre-set location of the camera when alarm is triggered
7. Select what kind of alarm situation is set for the sensor.

* Specifications are subject change without prior notice LAC Alarm System | Page 16

Input desired password and SMScode received on mobile

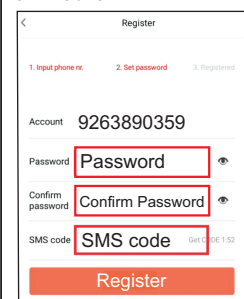

2. Power on the Device

Insert Micro SD Card then Power On

3. Camera Configuration

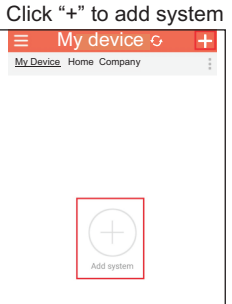

* Specifications are subject change without prior notice LAC Alarm System | Page 12

5. Mobile Application Interface

1. Direct View
2. Share the device to other user
3. Cloud Storage for the alarm videos
4. Details of the Camera (e.g. location)
5. 24/7 Video recording stored in the SD card
6. Delete the device from the user account
7. Arming/Disarming the System
8. Enable Motion Detection
9. Live Viewing
10. Alarm Events/Notification
11. Sensors added to the Camera
12. Adding Sensors

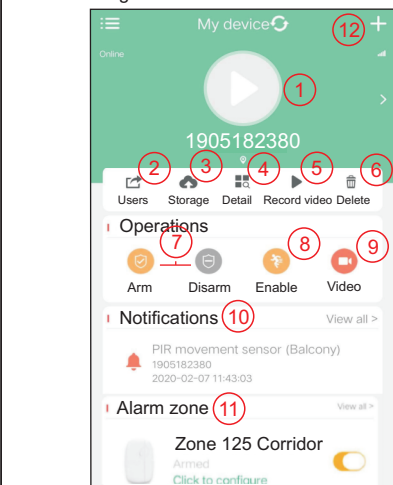

* Specifications are subject change without prior notice LAC Alarm System | Page 17

Select if adding (1) WiFi device or (2) LAN device

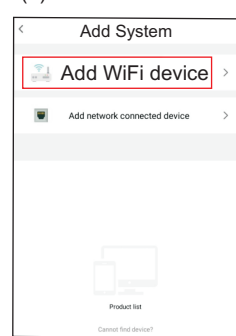

Select the device you want to add

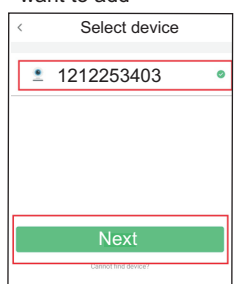

* Specifications are subject change without prior notice LAC Alarm System | Page 13

TECHNICAL PARAMETERS

MODEL	LADC22GB8F	LAPC22GE8F	LABC23GC8F
Radio Frequency	868MHz		
Sensor Connection	Max, 30 Wireless Sensors		
Image Sensor	1/2.7 CMOS		
Lens	3.6mm @F2.0		
Image Frame Rate	12ps maximum		
Resolution	2MP(1920 x 1080)		
Image Compression	H.265		
IR Distance	10M		
Day/Night Mode	IR Cut Filter with Auto switch;		
Input/Output	Two-way Audio, Built-in Micro Speaker		
Micro SD Capacity	Micro SD Card Maximum 128 GB		
Power Supply	DC5V/1A Micro-usb port	DC12V/1A	
Power Consumption	5W Max.		
Operating Temperature & Humidity	-10 to +50 °C (+14 to +124 °F); 10 ~ 80%RH non-condensing		
Storage Temperature & Humidity	-20°C ~ 60° (-4°F ~ 140°F); 0% ~ 90% non-condensing		

* Specifications are subject change without prior notice LAC Alarm System | Page 18

Select WIFI network where you connects your phone and input password



Wait for the system to be configure

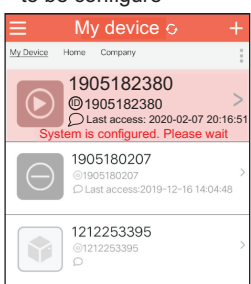

* Specifications are subject change without prior notice LAC Alarm System | Page 13

Set the location of the device then save

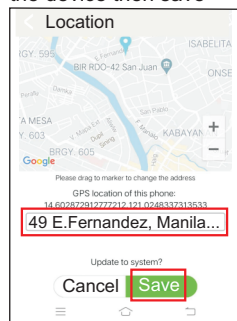

4. Sensor Configuration

4.1 Adding the sensors to alarm panel

Click "+" to add sensor

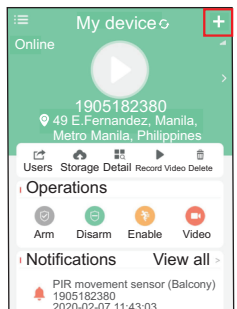

* Specifications are subject change without prior notice LAC Alarm System | Page 14

MODEL	LAD038F	LAM128F	LAS218F	LAI918F
Radio Frequency	868MHz			-
Standby Current	<15uA	<100uA	<20uA	<45mA
Alarm Current	<30mA			<150mA
Power	3.7V			AC110V ~ AC220V AC
Charging Voltage	<5.2V 3 Hours			<4.2V 8 Hours
Charging Current	<100mA	<400mA		-
Transmission Distance	Indoor: 30M; Outdoor: 90M			
Lithium Battery	3.7V 200mAh	3.7V 800mAh		
Working Environment	Temperature 0-50°, Humidity			97%
Detection Range	-	Distance: 10M*10M ; Angle: 110°	-	-
Smoke Sensitivity	-	-	0.2-0.6DB/M	
Alarm Decibel	-	-	1M Distance >85dB	1M Distance >90dB

* Specifications are subject change without prior notice LAC Alarm System | Page 19

Siren - press this button



Smoke Detector - press this button

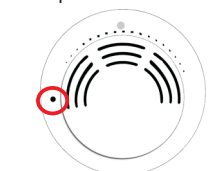

Connect the transmitter to the wired detector and trigger the device to send signal



Door Contact - press this button

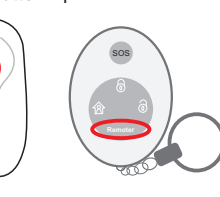
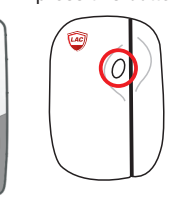

PIR - move with your hand



Select or input the location of the sensor

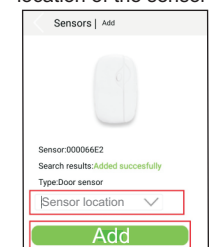

* Specifications are subject change without prior notice LAC Alarm System | Page 15

MODEL	LAP108F
Frequency	868MHz
Sensor Connection	50 Wireless & 2 Wired Alarm zones
Audio Input	Built in Microphone
Built in Siren	Support
Alarm Decibel	80dB
Alarm (RED)	System Arm (ON); System Disarm (OFF); Alarm (FLASH)
Power (YELLOW)	Battery (ON); DC Power (OFF); Low Battery (FLASH)
Network (BLUE)	Offline (ON); Online (OFF); Low GSM Signal (FLASH)
Battery	Rechargeable Lithium Battery 800mAh
Power Supply	DC5V 2A
Operating Temperature & Humidity	-5~+50°C; 10%~80%

MODEL	LAT248F	LAR828F
Frequency	868MHz	
Standby Current	<15uA	<15uA
Emission Current	20-30mA	<30mA
Working Power	12V	3V
Battery	23A 12V	CR2032 240mAh
Charging Voltage		
Transmission Distance	Indoor: 30M; Outdoor: 90M	

* Specifications are subject change without prior notice LAC Alarm System | Page 20